

Identification of enclosures

Connector inserts and their enclosures are numerous and therefore the search for the correct pairing of one with another can be complex.

To facilitate this operation (in addition to the normal part number) the definition of "size" has been introduced in this catalogue.

As indicated in the illustration on the left and in the table below the size value refers to the screw fixing centre distances which constitute a unique element since they are common to both the inserts and the enclosures.

All the pages that illustrate combinable articles (inserts and enclosures) carry references as per the examples illustrated on the opposite page.

Following is a table that shows all the sizes of the enclosures and the dimensions of the housings where the inserts will be fastened.

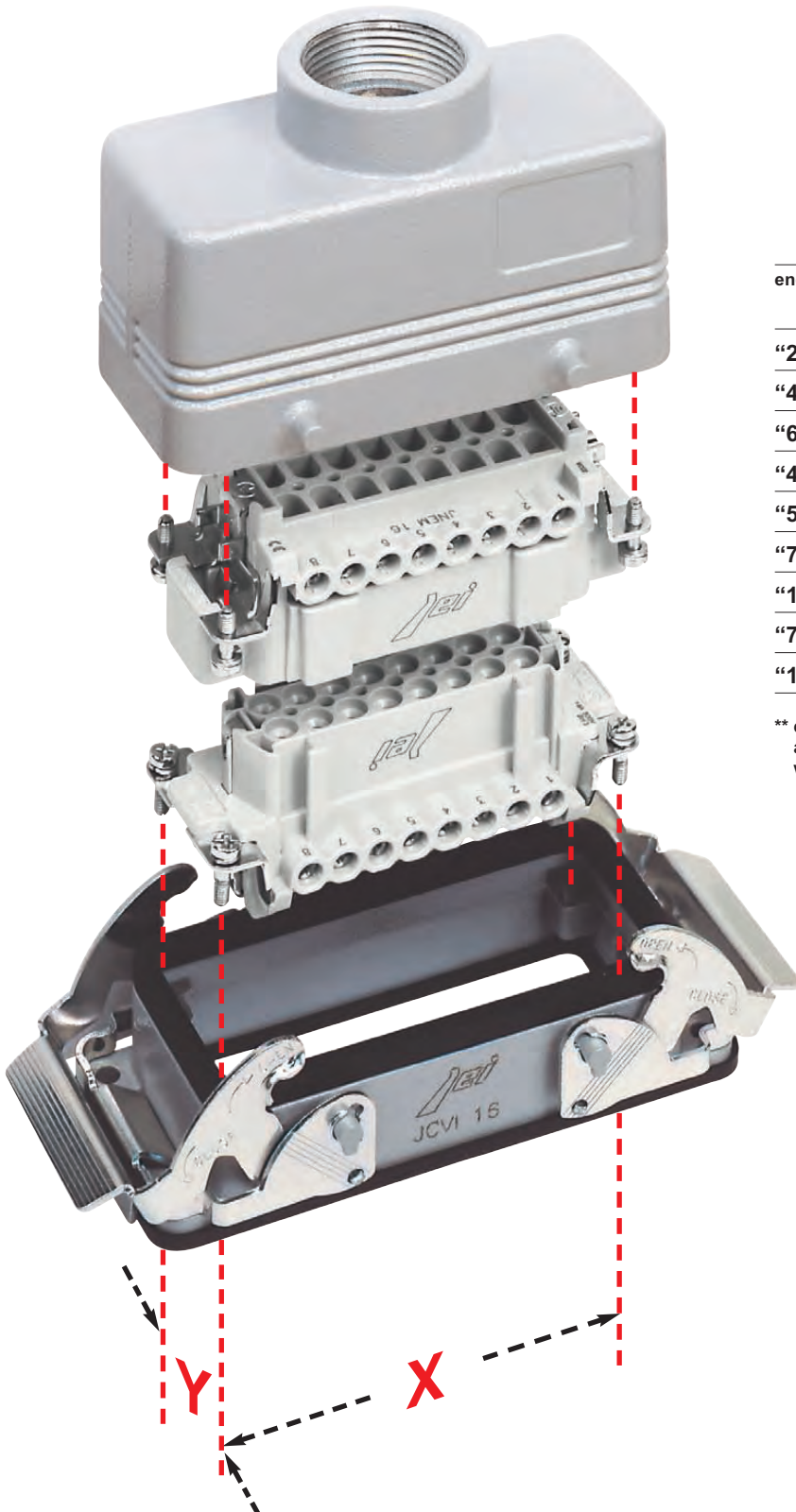

enclosures size	insert housing with screw fixing centre distance x-y
"21.21"	(21 x 21 mm) **
"49.16"	49,5 x 16 mm
"66.16"	66 x 16 mm
"44.27"	44 x 27 mm
"57.27"	57 x 27 mm
"77.27"	77,5 x 27 mm
"104.27"	104 x 27 mm
"77.62"	77,5 x 27 mm (2 inserts)
"104.62"	104 x 27 mm (2 inserts)

** dimensions relating to the insert cross-section size not being able to identify a screw fixing centre distance since provided with a single screw.

inserts: page:
CD 15 poles + ⊕ 33
JDA 10 poles + ⊕ 48

bulkhead mounting housings with single lever



thermoplastic lever

surface mounting housings with single lever



thermoplastic lever

description	part No.		part No.		part No.	
			entry Pg		entry M	
with single lever	JPI 15 L					
with single lever			JPP 15 L16	16	JMPP 15 L25	25
with single lever			JPP 15 L216	16 x 2	JMPP 15 L225	25 x 2
with single lever			JPP 15 L21	21		

panel cut-out for bulkhead mounting housings in mm

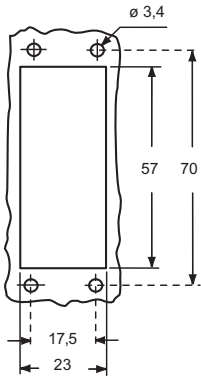

dimensions in mm

JPI L

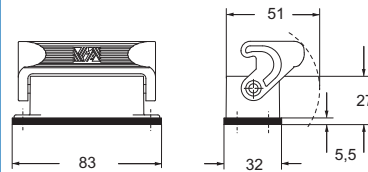

dimensions in mm

JPP L and JMPP L

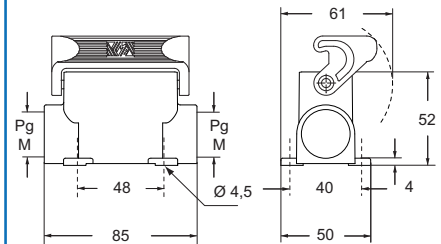

CALUS® Type 4/4X/12



dimensions shown are not binding and may be changed without notice

inserts: page:
CD 15 poles + ⊕ 33
JDA 10 poles + ⊕ 48

Cover versions L and LG cannot be used together with coding pins. If this application is required, please contact ILME SpA.

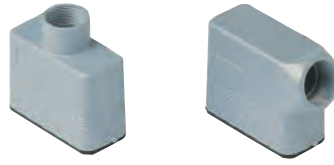
hoods with 2 pegs

hoods with single lever covers with 2 pegs and single lever

thermoplastic lever

description	part No.		part No.		part No.		part No.	
		entry Pg		entry M		entry Pg		entry M
with pegs, side entry	CZO 15 L	16	MZO 15 L20	20				
with pegs, side entry			MZO 15 L25	25				
with pegs, top entry	CZV 15 L	13,5	MZV 15 L20	20				
with pegs, side entry, high construction, without adaptor *	CZFO 15 L16	16	MZFO 15 L20	20				
with pegs, side entry, high construction, without adaptor *	CZFO 15 L21	21	MZFO 15 L25	25				
with pegs, top entry, high construction, without adaptor *	CZFO 15 L16	16	MZFO 15 L20	20				
with pegs, top entry, high construction, without adaptor *	CZFO 15 L21	21	MZFO 15 L25	25				
with single lever, top entry					JPV 15 LG13	13,5	JMPV 15 LG20	20
with pegs (for enclosures with single lever)					CZC 15 L			
with single lever (for hoods with pegs)					JPC 15 LG			

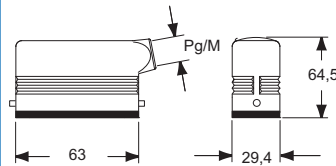
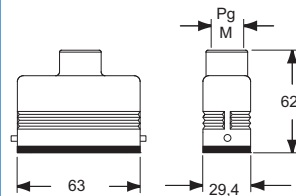
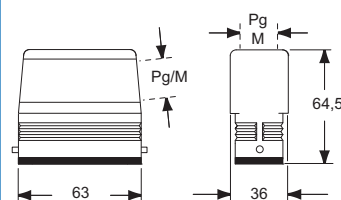
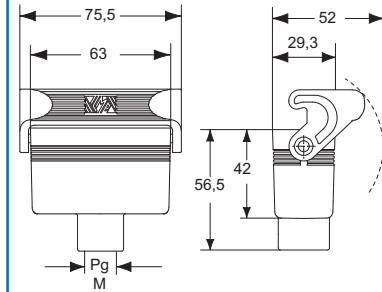
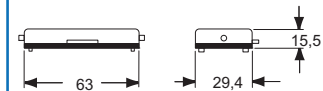
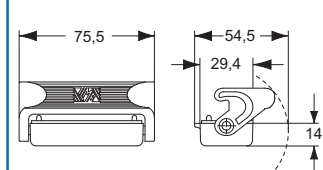
* enclosure without adaptor, threaded on the body, to enclosure to be used only with a complete cable gland.

dimensions in mm
CZO L and MZO L

CZV L and MZV L

CZFO L - MZFO L and CZFV L - MZFV L

dimensions in mm
JPV LG and JMPV LG

CZC L

JPC LG

Type 4/4X/12

(excluding cover JPC 15 LG)



dimensions shown are not binding and may be changed without notice

inserts:

page:

CD	25 poles + ⊕	34
CDD	38 poles + ⊕	41
JDA	16 poles + ⊕	49

bulkhead mounting housings with single lever



thermoplastic lever

surface mounting housings with single lever



thermoplastic lever

description

part No.

part No.

entry Pg

part No.

entry M

with single lever

JPI 25 L

with single lever
with single lever
with single lever

JPP 25 L16 16
JPP 25 L216 16 x 2
JPP 25 L21 21

JMPP 25 L25 25
JMPP 25 L225 25 x 2

panel cut-out for bulkhead mounting housings in mm

dimensions in mm

dimensions in mm

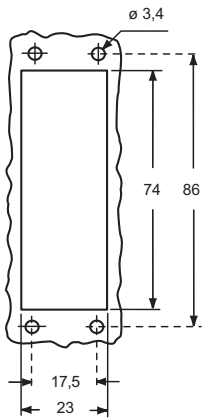

JPI L

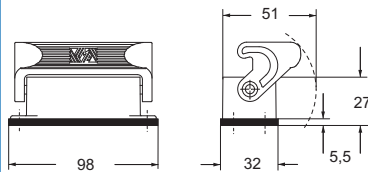

JPP L and JMPP L

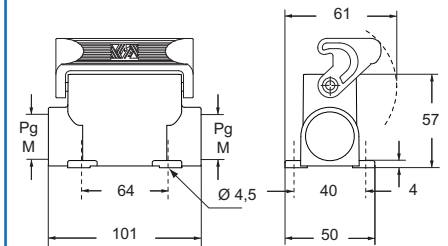

CULUS Type 4/4X/12



dimensions shown are not binding and may be changed without notice

inserts: page:

CD	25 poles + ⊕	34
CDD	38 poles + ⊕	41
JDA	16 poles + ⊕	49

Cover versions L and LG cannot be used together with coding pins. If this application is required, please contact ILME SpA.

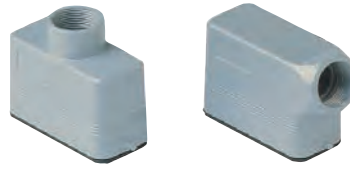
hoods with 2 pegs

hoods with single lever covers with 2 pegs and single lever

thermoplastic lever

description	part No.		part No.		part No.		part No.	
		entry Pg		entry M		entry Pg		entry M
with pegs, side entry	CZO 25 L	16	MZO 25 L20	20				
with pegs, side entry			MZO 25 L25	25				
with pegs, top entry	CZV 25 L	16	MZV 25 L20 **	20				
with pegs, side entry, high construction, without adaptor *	CZFO 25 L16	16	MZFO 25 L20	20				
with pegs, side entry, high construction, without adaptor *	CZFO 25 L21	21	MZFO 25 L25	25				
with pegs, top entry, high construction, without adaptor *	CZFO 25 L16	16	MZFO 25 L20	20				
with pegs, top entry, high construction, without adaptor *	CZFO 25 L21	21	MZFO 25 L25	25				
with single lever, top entry					JPV 25 LG16	16	JMPV 25 LG20 **	20
with pegs (for enclosures with single lever)					CZC 25 L			
with single lever (for hoods with pegs)					JPC 25 LG			

* enclosure without adaptor, threaded on the body, to enclosure to be used only with a complete cable gland.

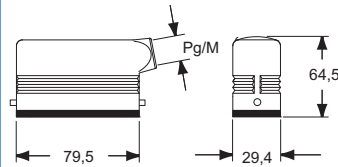
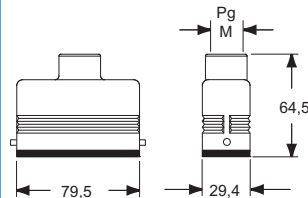
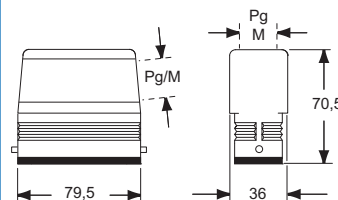
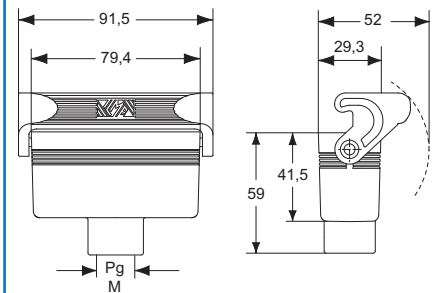
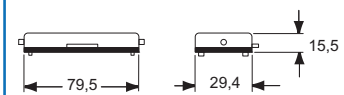
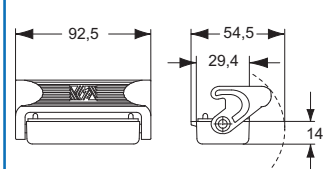
** can only be used with a complete cable gland (to be purchased separately).

dimensions in mm
CZO L and MZO L

CZV L and MZV L

CZFO L - MZFO L and CZFV L - MZFV L

dimensions in mm
JPV LG and JMPV LG

CZC L

JPC LG

Type 4/4X/12

(excluding cover JPC 25 LG)



dimensions shown are not binding and may be changed without notice

inserts:

page:

CDD	24 poles + ⊕	40
JDS	9 poles + ⊕	54
JSH	6 poles + ⊕	62
JNE, JSE	6 poles + ⊕	68
CCE	6 poles + ⊕	74
CQE	10 poles + ⊕	81

insert centre distance:
44 x 27 mm

bulkhead mounting housings with single lever



thermoplastic lever

surface mounting housings with single lever



thermoplastic lever

description

part No.

part No.

entry Pg

part No.

entry M

with single lever

JPI 06 L

with single lever
with single lever
with single lever, high construction
with single lever, high construction

JPP 06 L16	16	JMPP 06 L20	20
JPP 06 L216	16 x 2	JMPP 06 L220	20 x 2
JPAP 06 L21	21	JMPAP 06 L32	32
JPAP 06 L221	21 x 2	JMPAP 06L232	32 x 2

panel cut-out for bulkhead mounting housings in mm

dimensions in mm

dimensions in mm

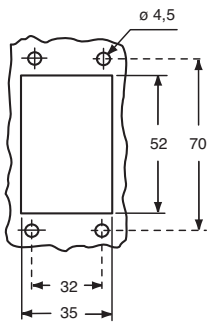

JPI L

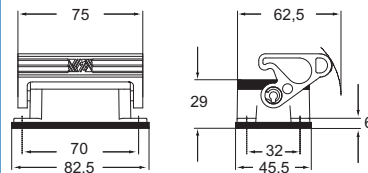

JPP L - JPAP L and JMPP L - JMPAP L

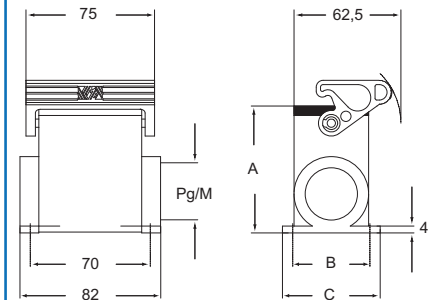

type	A	B	C
JPP L / JMPP L	53	40	52
JPAP L / JMPAP L	74	45	57

CALUS® Type 4/4X/12



dimensions shown are not binding and may be changed without notice

inserts:

page:

CDD	24 poles + ⊕	40
JDS	9 poles + ⊕	54
JSH	6 poles + ⊕	62
JNE, JSE	6 poles + ⊕	68
CCE	6 poles + ⊕	74
CQE	10 poles + ⊕	81

insert centre distance:
44 x 27 mm

hoods with 2 pegs



hoods with gasket and 1 lever covers with 2 pegs and 1 lever



thermoplastic lever

description	part No.		part No.		part No.		part No.	
		entry Pg		entry M		entry Pg		entry M
with pegs, side entry	CHO 06 L13	13,5	MHO 06 L20	20				
with pegs, side entry	CHO 06 L16	16	MHO 06 L25	25				
with pegs, side entry, high construction, without adaptor *	CFO 06 L21	21	MFO 06 L25	25				
with pegs, side entry, high construction, without adaptor *	CFO 06 L29	29	MFO 06 L32	32				
with pegs, top entry	CHV 06 L13	13,5	MHV 06 L20	20				
with pegs, top entry	CHV 06 L16	16	MHV 06 L25	25				
with pegs, top entry, high construction, without adaptor *	CFV 06 L21	21	MFV 06 L25	25				
with pegs, top entry, high construction, without adaptor *	CFV 06 L29	29	MFV 06 L32	32				
with single lever, top entry					JPV 06 LG16	16	JMPV 06 LG25	25
with single lever (for hoods with pegs)					JPC 06 LG			
with pegs (for enclosures with single lever)					CHC 06 L			

* enclosure without adaptor, threaded on the body, to enclosure to be used only with a complete cable gland.

dimensions in mm

CHO L and MHO L

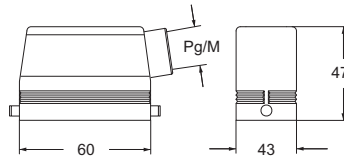

CHV L and MHV L

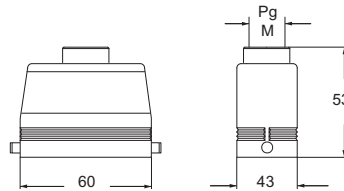

CFO L and MFO L - CFV L and MFV L

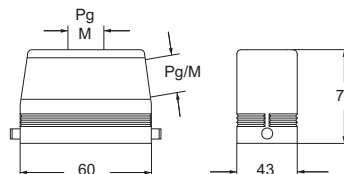

dimensions in mm

JPV LG and JMPV LG

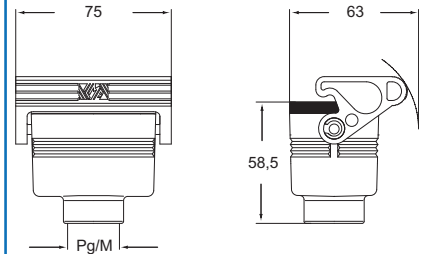

JPC LG

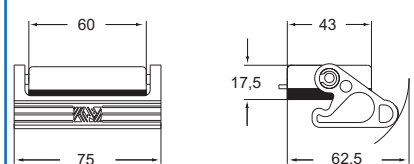

CHC L

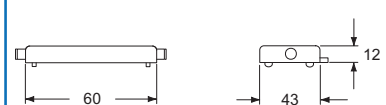

CRUS Type 4/4X/12



dimensions shown are not binding and may be changed without notice

inserts:

page:

CDD	42 poles + ⊕	42
JDS	18 poles + ⊕	55
JSH	10 poles + ⊕	63
JNE, JSE	10 poles + ⊕	69
CCE	10 poles + ⊕	75
CQE	18 poles + ⊕	82

insert centre distance:
57 x 27 mm

bulkhead mounting housings with 2 levers



thermoplastic lever

surface mounting housings with 2 levers



thermoplastic lever

description

part No.

part No.

entry Pg

part No.

entry M

with levers

JPI 10

with levers
with levers, high construction
with levers, high construction

JPP 10.16	16	JMPP 10.20	20
JPP 10.216	16 x 2	JMPP 10.220	20 x 2
JPAP 10.21	21	JMPAP 10.32	32
JPAP 10.221	21 x 2	JMPAP 10.232	32 x 2

panel cut-out for bulkhead mounting housings in mm

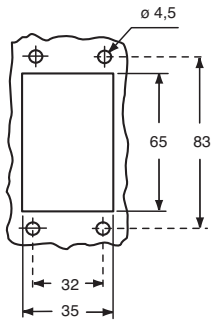

dimensions in mm

JPI

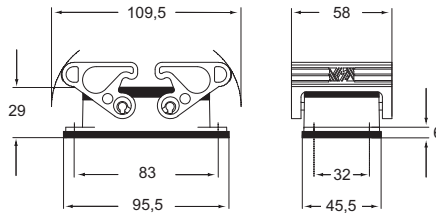

dimensions in mm

JPP - JPAP and JMPP - JMPAP

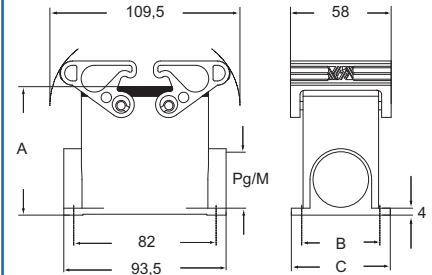

type	A	B	C
JPP - JMPP 10	57	40	52
JPAP - JMPAP 10	74	45	57

CALUS Type 4/4X/12



dimensions shown are not binding and may be changed without notice

inserts:

page:

CDD	42 poles + ⊕	42
JDS	18 poles + ⊕	55
JSH	10 poles + ⊕	63
JNE, JSE	10 poles + ⊕	69
CCE	10 poles + ⊕	75
CQE	18 poles + ⊕	82

insert centre distance:
57 x 27 mm

hoods with 4 pegs



hoods with gasket and 2 levers
covers with 4 pegs and 2 levers



thermoplastic lever

description	hoods with 4 pegs		hoods with gasket and 2 levers	
	part No.	entry Pg	part No.	entry M
with pegs, side entry	CHO 10	16	MHO 10.20	20
with pegs, side entry			MHO 10.25	25
with pegs, side entry, high construction	CAO 10.21	21	MAO 10.32	32
with pegs, side entry, high construction	CAO 10.29	29	MAO 10.40	40
with pegs, side entry, high construction, without adaptor *	CFO 10.21	21	MFO 10.32	32
with pegs, side entry, high construction, without adaptor *	CFO 10.29	29	MFO 10.40	40
with pegs, top entry	CHV 10	16	MHV 10.20 **	20
with pegs, top entry			MHV 10.25	25
with pegs, top entry, high construction	CAV 10.21	21	MAV 10.32	32
with pegs, top entry, high construction	CAV 10.29	29	MAV 10.40	40
with pegs, top entry, high construction, without adaptor *	CFV 10.21	21	MFV 10.32	32
with pegs, top entry, high construction, without adaptor *	CFV 10.29	29	MFV 10.40	40
with levers, top entry			JPV 10 G16	16
			JMPV 10 G25	25
with levers (for hoods with pegs)			JPC 10 G	
with pegs (for enclosures with levers and gasket)			CHC 10	

* enclosure without adaptor, threaded on the body, to enclosure to be used only with a complete cable gland.

** can only be used with a complete cable gland (to be purchased separately).

dimensions in mm

CHO (CAO) and MHO (MAO)

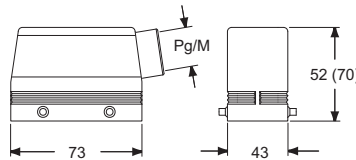

CHV (CAV) and MHV (MAV)

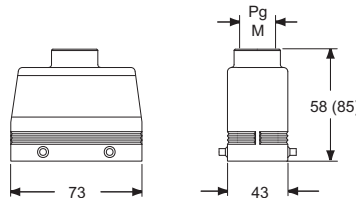

CFO - MFO and CFV - MFV

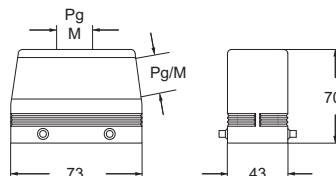

dimensions in mm

JPV G and JMPV G

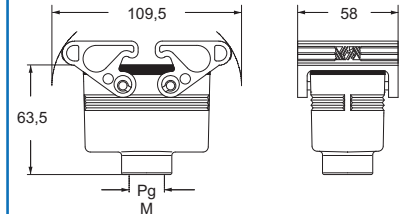

JPC G

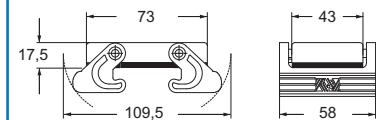

CHC

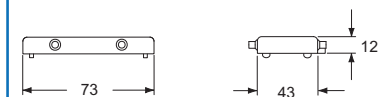

CALUS Type 4/4X/12



dimensions shown are not binding and may be changed without notice

inserts:	page:
CD 40 poles + ⊕	35
CDD 72 poles + ⊕	43
JDS 27 poles + ⊕	56
JSH 16 poles + ⊕	64
JNE, JSE 16 poles + ⊕	70
CCE 16 poles + ⊕	76
CQE 32 poles + ⊕	83

insert centre distance:
77,5 x 27 mm

bulkhead mounting housings with 2 levers



thermoplastic lever

surface mounting housings with 2 levers



thermoplastic lever

description

part No.

part No.

entry Pg

part No.

entry M

with levers

JPI 16

with levers
with levers
with levers, high construction
with levers, high construction

JPP 16.21	21	JMPP 16.25	25
JPP 16.221	21 x 2	JMPP 16.225	25 x 2
JPAP 16.29	29	JMPAP 16.32	32
JPAP 16.229	29 x 2	JMPAP 16.232	32 x 2

panel cut-out for bulkhead mounting housings in mm

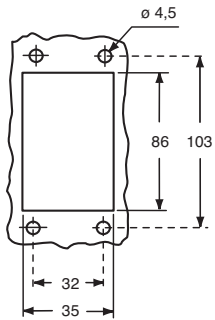

dimensions in mm

JPI

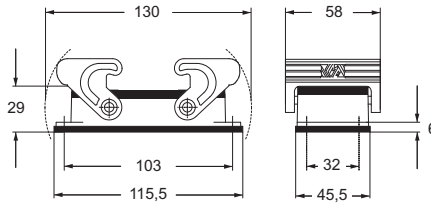

dimensions in mm

JPP - JPAP and JMPP - JMPAP

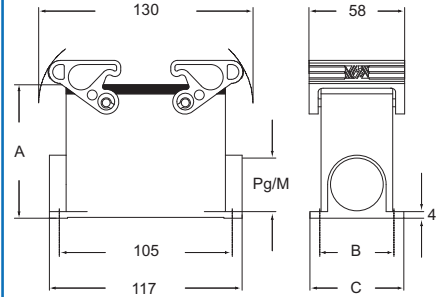

type	A	B	C
JPP - JMPP 16	63	45	57
JPAP - JMPAP 16	81	45	57

CRUS Type 4/4X/12



dimensions shown are not binding and may be changed without notice

inserts:

page:

CD	40 poles + ⊕	35
CDD	72 poles + ⊕	43
JDS	27 poles + ⊕	56
JSH	16 poles + ⊕	64
JNE, JSE	16 poles + ⊕	70
CCE	16 poles + ⊕	76
CQE	32 poles + ⊕	83

 insert centre distance:
77,5 x 27 mm
hoods with 4 pegs

hoods with gasket and 2 levers covers with 4 pegs and 2 levers



thermoplastic lever

description	part No.		part No.		part No.		part No.	
		entry Pg		entry M		entry Pg		entry M
with pegs, side entry	CHO 16	21	MHO 16.25	25				
with pegs, side entry			MHO 16.32	32				
with pegs, side entry, high construction	CAO 16.21	21	MAO 16.32	32				
with pegs, side entry, high construction	CAO 16.29	29	MAO 16.40	40				
with pegs, side entry, high construction, without adaptor *	CFO 16.21	21	MFO 16.32	32				
with pegs, side entry, high construction, without adaptor *	CFO 16.29	29	MFO 16.40	40				
with pegs, top entry	CHV 16	21	MHV 16.25 **	25				
with pegs, top entry			MHV 16.32	32				
with pegs, top entry, high construction	CAV 16.21	21	MAV 16.32	32				
with pegs, top entry, high construction	CAV 16.29	29	MAV 16.40	40				
with pegs, top entry, high construction, without adaptor *	CFV 16.21	21	MFV 16.32	32				
with pegs, top entry, high construction, without adaptor *	CFV 16.29	29	MFV 16.40	40				
with levers, top entry					JPV 16 G21	21	JMPV 16 G32	32
with levers (for hoods with pegs)					JPC 16 G			
with pegs (for enclosures with levers and gasket)					CHC 16			

* enclosure without adaptor, threaded on the body, to enclosure to be used only with a complete cable gland.

** can only be used with a complete cable gland (to be purchased separately).

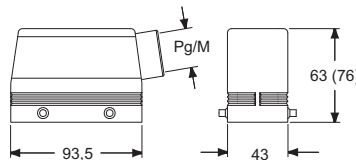
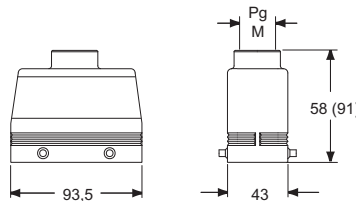
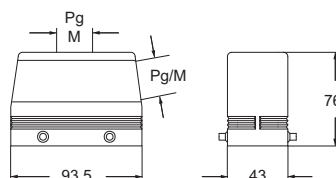
dimensions in mm

CHO (CAO) and MHO (MAO)

CHV (CAV) and MHV (MAV)

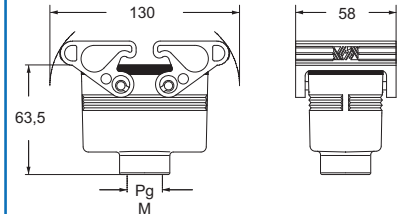
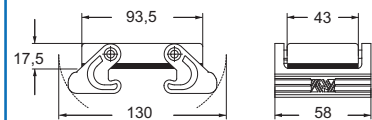
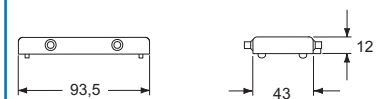
CFO - MFO and CFV - MFV

dimensions in mm

JPV G and JMPV G

JPC G

CHC

 Type
4/4X/12

 dimensions shown are not binding
 and may be changed without notice

inserts:

page:

CD.....	64 poles + ⊕	36
CDD.....	108 poles + ⊕	44
JDS.....	42 poles + ⊕	57
JSH.....	24 poles + ⊕	65
JNE, JSE.....	24 poles + ⊕	71
CCE.....	24 poles + ⊕	77
CQE.....	46 poles + ⊕	84

insert centre distance:
104 x 27 mm

bulkhead mounting housings with 2 levers



thermoplastic lever

surface mounting housings with 2 levers



thermoplastic lever

description

part No.

part No.

entry Pg

part No.

entry M

with levers

JPI 24

with levers
with levers
with levers, high construction
with levers, high construction

JPP 24.21	21	JMPP 24.25	25
JPP 24.221	21 x 2	JMPP 24.225	25 x 2
JPAP 24.29	29	JMPAP 24.32	32
JPAP 24.229	29 x 2	JMPAP 24.232	32 x 2

panel cut-out for bulkhead mounting housings in mm

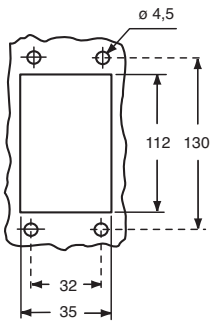

dimensions in mm

JPI

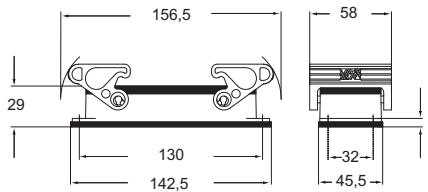

dimensions in mm

JPP - JPAP and JMPP - JMPAP

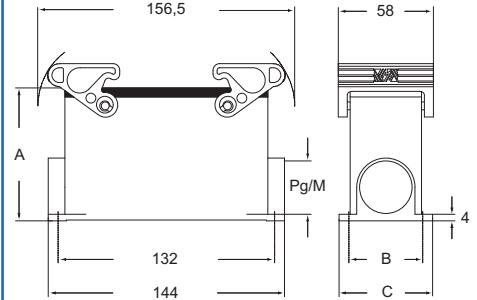

type	A	B	C
JPP - JMPP 24	63	45	57
JPAP - JMPAP 24	81	45	57

CALUS Type 4/4X/12



dimensions shown are not binding and may be changed without notice

inserts:

page:

CD	64 poles + ⊕	36
CDD	108 poles + ⊕	44
JDS	42 poles + ⊕	57
JSH	24 poles + ⊕	65
JNE, JSE	24 poles + ⊕	71
CCE	24 poles + ⊕	77
CQE	46 poles + ⊕	84

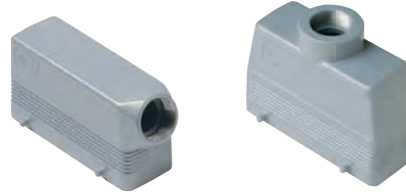
 insert centre distance:
104 x 27 mm
hoods with 4 pegs

hoods with gasket and 2 levers covers with 4 pegs and 2 levers



thermoplastic lever

description	part No.		part No.		part No.		part No.	
		entry Pg		entry M		entry Pg		entry M
with pegs, side entry	CHO 24	21	MHO 24.25	25				
with pegs, side entry			MHO 24.32	32				
with pegs, side entry, high construction	CAO 24.21	21	MAO 24.32	32				
with pegs, side entry, high construction	CAO 24.29	29	MAO 24.40	40				
with pegs, side entry, high construction, without adaptor *	CFO 24.21	21	MFO 24.32	32				
with pegs, side entry, high construction, without adaptor *	CFO 24.29	29	MFO 24.40	40				
with pegs, top entry	CHV 24	21	MHV 24.25 **	25				
with pegs, top entry			MHV 24.32	32				
with pegs, top entry	CHV 24.29	29	MHV 24.40	40				
with pegs, top entry, high construction	CAV 24.21	21	MAV 24.32	32				
with pegs, top entry, high construction	CAV 24.29	29	MAV 24.40	40				
with pegs, top entry, high construction, without adaptor *	CFV 16.21	21	MFV 16.32	32				
with pegs, top entry, high construction, without adaptor *	CFV 16.29	29	MFV 16.40	40				
with levers, top entry					JPV 24 G21	21	JMPV 24 G32	32
with levers (for hoods with pegs)					JPC 24 G			
with pegs (for enclosures with levers and gasket)					CHC 24			

* enclosure without adaptor, threaded on the body, to enclosure to be used only with a complete cable gland.

** can only be used with a complete cable gland (to be purchased separately).

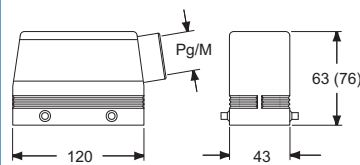
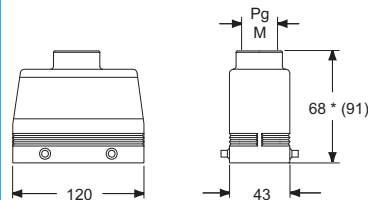
dimensions in mm

CHO (CAO) and MHO (MAO)

CHV (CAV) and MHV (MAV)

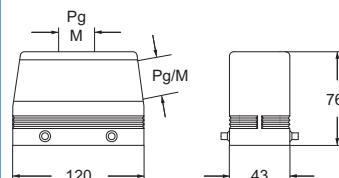
* 69,5 for Pg 29 - M 40 versions

CFO - MFO and CFV - MFV

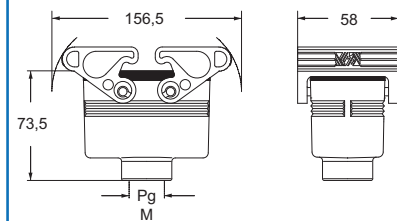
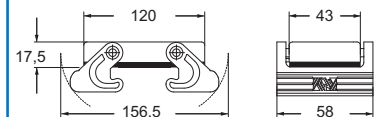
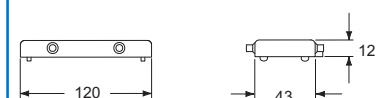
dimensions in mm

JPV G and JMPV G

JPC G

CHC

 Type
4/4X/12

 dimensions shown are not binding
 and may be changed without notice

inserts:

page:

CD	80 poles + ⊕	37
CDD	144 poles + ⊕	45
JDS	54 poles + ⊕	58
JSH	32 poles + ⊕	66
JNE, JSE	32 poles + ⊕	72
CCE	32 poles + ⊕	78
CQE	64 poles + ⊕	85

insert centre distance:
2 x (77,5 x 27) mm

bulkhead mounting housings with 2 levers



thermoplastic lever

surface mounting housings with 2 levers



thermoplastic lever

description

part No.

part No.

entry Pg

part No.

entry M

with levers

JPI 32

with levers

JPP 32.29

JMPP 32.40

with levers

JPP 32.229

JMPP 32.240

with levers

JPP 32.36

JMPP 32.240

with levers

JPP 32.236

JMPP 32.240

panel cut-out for bulkhead mounting housings in mm

dimensions in mm

dimensions in mm

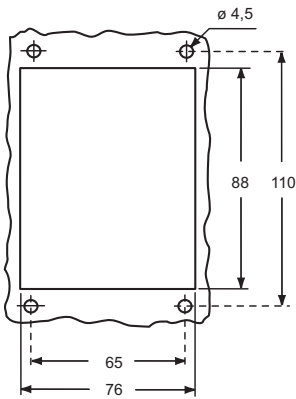

JPI

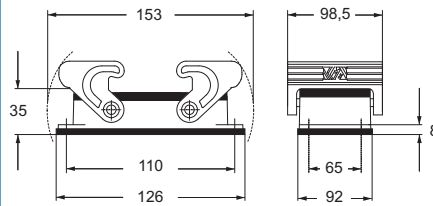

JPP and JMPP

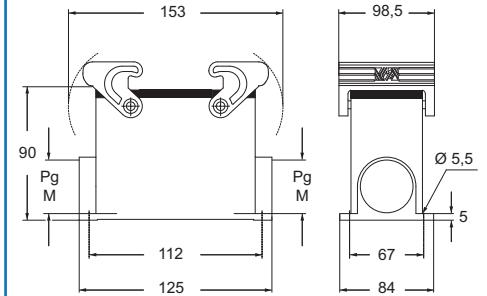

CRAUS Type 4/4X/12



dimensions shown are not binding and may be changed without notice

inserts:

page:

CD.....	80 poles + ⊕	37
CDD.....	144 poles + ⊕	45
JDS.....	54 poles + ⊕	58
JSH.....	32 poles + ⊕	66
JNE, JSE.....	32 poles + ⊕	72
CCE.....	32 poles + ⊕	78
CQE.....	64 poles + ⊕	85

insert centre distance:
2 x (77,5 x 27) mm

hoods with 4 pegs



hoods with gasket and 2 levers
covers with 4 pegs and 2 levers



thermoplastic lever

description	part No.		part No.		part No.		part No.	
		entry Pg		entry M		entry Pg		entry M
with pegs, side entry, without adaptor *	CFO 32.29	29	MFO 32.32	32				
with pegs, side entry, without adaptor *	CFO 32.36	36	MFO 32.40	40				
with pegs, top entry, without adaptor *	CFV 32.29	29	MFV 32.32	32				
with pegs, top entry, without adaptor *	CFV 32.36	36	MFV 32.40	40				
with levers, top entry, without adaptor *					JPFV 32 G36	36	JMPFV 32 G40	40
with levers (for hoods with pegs)					JPC 32 G			
with pegs (for enclosures with levers and gasket)					CHC 32			

* enclosure without adaptor, threaded on the body, to enclosure to be used only with a complete cable gland.

dimensions in mm

CFO and MFO

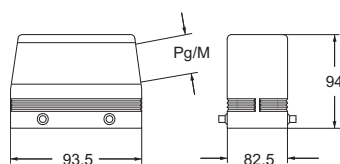

CFV and MFV

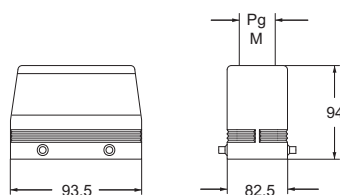

dimensions in mm

JPFV G and JMPFV G

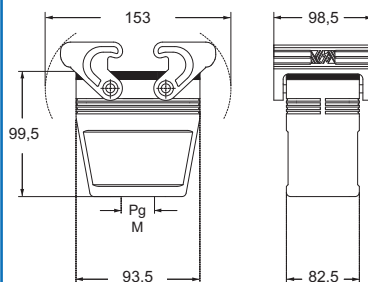

JPC G

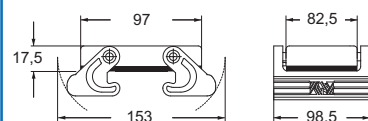

CHC



CRAUS Type 4/4X/12



dimensions shown are not binding and may be changed without notice